

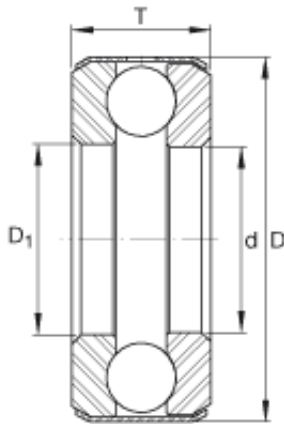

NTN Driveshaft CORP.



INA D36 thrust ball bearings

Bearing No. D36

Size	68.263x110.338x25.4 mm
Bore Diameter	68,263 mm
Outer Diameter	110,338 mm
Width	25,4 mm
d	2 11/16 inch
d	68,263 mm
D	4,344 inch
D	110,338 mm
T	1 inch
T	25,4 mm
D ₁	2,719 inch
m	1,88 lbs / Weight
m	854 g / Weight
C _a	18100 lbf / Dynamic load rating (axial)
C _a	81000 N / Dynamic load rating (axial)
C _{0a}	49000 lbf / Static load rating (axial)
C _{0a}	218000 N / Static load rating (axial)
Category	Thrust Ball Bearing
Inventory	0.0
Manufacturer Name	SCHAEFFLER GROUP
Minimum Buy Quantity	N/A
Weight / Kilogram	1.023
EAN	4012802118094

D36 Bearing 2D drawings and 3D CAD models



NTN Driveshaft CORP.

Product Group	B00308
Rolling Element	Ball Bearing
Thrust Bearing	Yes
Single or Double Direction	Single Direction
Banded	Yes
Precision Class	ABEC 1 ISO P0
Component Description	Roller Assembly Plus Raceways
Other Features	Single Row Deep Groove Medium Cross Section Grooved Race Non Separable Full Complement Standard Oil Hole in Band
Long Description	2-11/16" Bore 1; 2-23/32" Bore 2; 4-11/32" Outside Diameter; 1" Height; Ball Bearing; Single Direction; Banded; ABEC 1 ISO P0 Precision
Inch - Metric	Inch
Category	Thrust Ball Bearings
UNSPSC	31171507
Harmonized Tariff Code	8482.10.50.08
Noun	Bearing
Keyword String	Ball Thrust
Manufacturer URL	http://www.ina.com
Manufacturer Item Number	D36
Weight / LBS	1.88
Bore 2	2.719 Inch 69.063 Millimeter
Outside Diameter	4.344 Inch 110.338 Millimeter
Height	1 Inch 25.4 Millimeter
Bore 1	2.688 Inch 68.275 Millimeter



NTN Driveshaft CORP.

Overall Height with Aligning Washer	0 Inch 0 Millimeter
--	-----------------------