

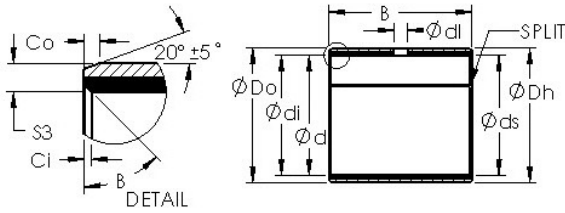

NTN Driveshaft CORP.



AST AST50 44IB60 plain bearings

Bearing No. AST50 44IB60

| | |
|--|---|
| Bore Diameter | 69,85 mm |
| Bearing Type | straight |
| Shaft Dia., Nominal (d) | 2.7500 |
| Shaft Size (ds) - 2.75 | 2.7482 |
| Housing Bore Dia. (Dh) - 2.937 | 2.9358 |
| Bearing Bore after Mounting (di) - 2.7566 | 2.7502 |
| Average Clearance (Cd) | 0.0038 |
| Wall Thickness (S3) | 0.095 |
| Bearing Length, Nominal (B) | 3.750 |
| Bearing Length Tolerance (B tol.) - +.010 / -0.010 | +.010 / 0.010 |
| OD Chamfer Length (Co) | 0.072 |
| ID Chamfer Angle (B deg.) | 30 |
| ID Chamfer Length (Ci) | 0.031 |
| Material | Carbon steel shell with PTFE / Fiber lining |

AST50 44IB60 Bearing 2D drawings and 3D CAD models